

Indoor Wi-Fi In-Wall Switch

INSTRUCTION GUIDE

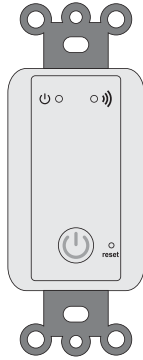

125Vac, 60Hz, 15A Resistive,
15A General Use, 1000W Tungsten,
500VA Electronic Ballast,
120Vac, 60Hz, 8.3A Ballast, 1/2HP.



INSTALLING



Warning: To avoid fire and/or shock, turn off power. Make sure the power is off before wiring. If you are unsure or uncomfortable with installation, contact a licensed electrician.

CAUTION! INDOOR USE ONLY! Do not use the Wi-Fi In-Wall Switch outdoors or in damp or wet locations.

Package Contents:

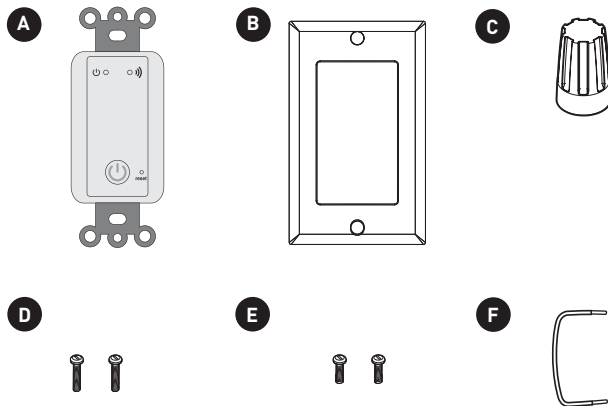

* Tools Required for Assembly (not included): screwdriver.

PART	DESCRIPTION	QUANTITY
A	Switch	1
B	Wall plate	1
C	Wire nuts	2
D	Mounting screws (Wall box)	0.748 in. - 2
E	Mounting screws (Wall plate)	0.33 in. - 2
F	Jumper wire	15 cm - 1

Step1

This device is to be installed in a single gang box measuring at least 3" x 2" x 2.5" (standard single gang box) and wired in accordance with NEC.

Step2

Straighten each conductor and strip 1/2" of insulation from each wire.

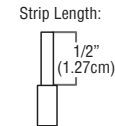

Step3

Begin by loosening all the screws on your ECO In-Wall switch. You'll notice there is now a loose plate in the hole. The wires will need to be inserted in the middle and tightened with a screwdriver. (See figure 3).

The screw terminals accept up to 12AWG copper wire.

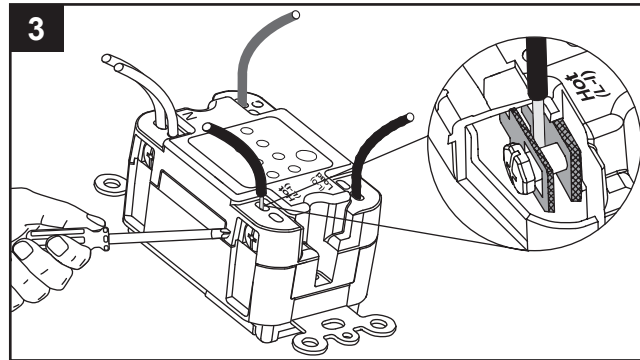

Step4

Wiring the Wi-Fi In-Wall switch.

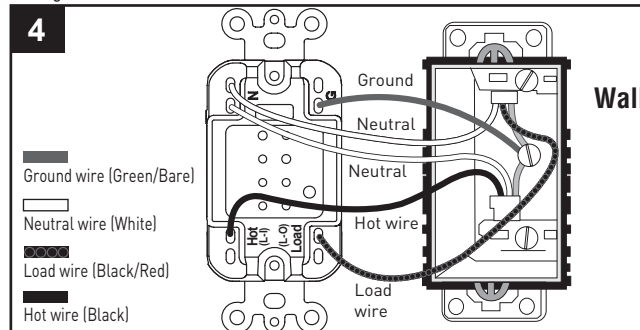

Step4 Cont.

1. Insert the ground wire(s) into hole(s) labeled "G" (near green screw)
2. Insert 2 neutral wires into the holes labeled "N" (near silver screw)
3. Insert the hot wire into the hole labeled "L-1" (near brass screw)
4. Insert the load wire into the hole labeled "L-0" (near brass screw)

Step5

The ECO In-Wall switch requires a neutral wire connection or the switch will not work.

5-1. If the existing neutral (white) wires are connected by wire nut in the wall box, release the nut, insert both neutral wires into the holes labeled N (near silver screw). (See figure 5-1).

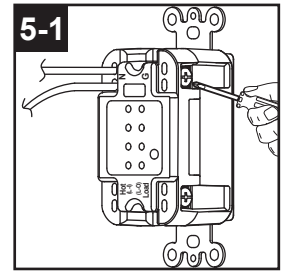

5-2. If the neutral wires from the wall box are short and do not reach the N hole, cut the wire at 1-1/4 in. (include the period) from the bottom of case, remove jacket at 1/2 in. (include the period) of both ends. Insert longer cord to N hole. Connect the shorter cord with enclosed jumper wire (F) and wire nut, then insert to another N hole (near silver screw) (See figure 5-2).

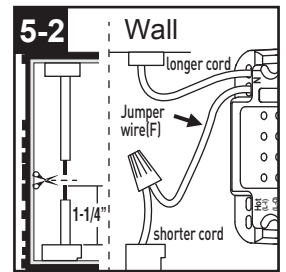

5-3. Tighten all screws firmly. (12lbf-in). (See figure 5-3).

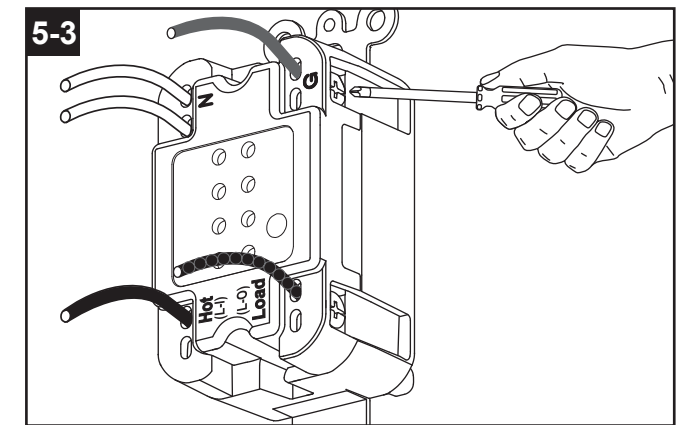

Step6

Carefully fold wire into the wall box and mount the Wi-Fi In-Wall switch (A) into wall box using the mounting screws (D), then attach the wall place using the mounting screws(F). (See figure 6).

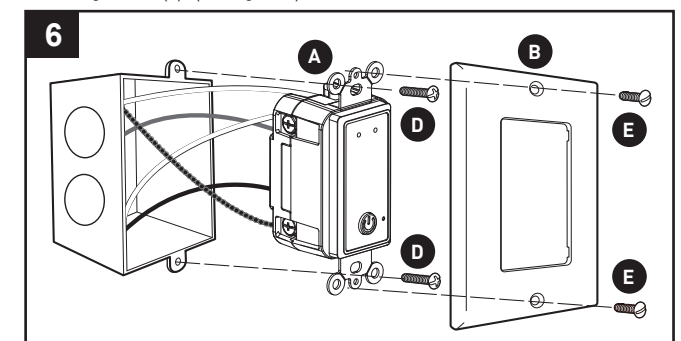

Step7

Restore power by flipping the breaker to the "on" position or re-installing the fuse to the circuit.

SETUP INSTRUCTION



READ ALL INSTRUCTIONS before using the Wi-Fi In-Wall Switch.

RECOMMENDATION: The closer the Wi-Fi In-Wall Switch is located to a Wi-Fi router during set-up, the better the signal strength will be for initial configuration and subsequent programming.

Mac address: If your router identifies by Mac address, please key in the code number shown in the code label of the unit. i.e., 3x:2x:7x:0x:Cx:Cx

CAUTION! INDOOR USE ONLY! RISK OF ELECTRIC SHOCK. Use this product only in dry, indoor locations.



Wi-Fi Home Router

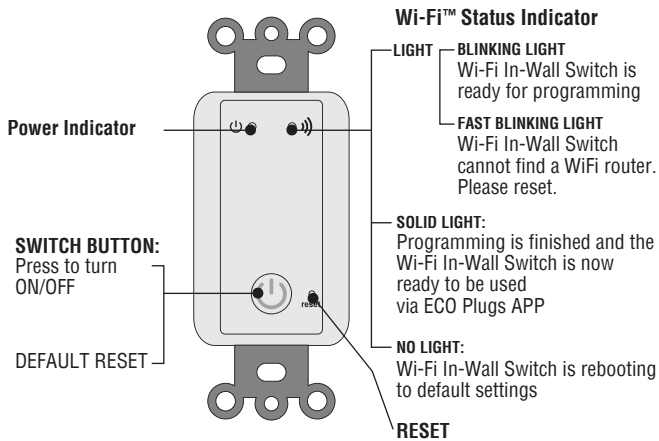

RESET THE WI-FI IN-WALL SWITCH

This is how you perform a factory reset of the Wi-Fi In-Wall switch

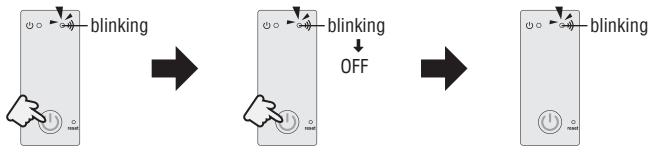

STEP 1
Press and hold the power button Insert a non-conducting stick into the RESET hole, then release it

STEP 2
Hold the power button until the Wi-Fi In-Wall indicator light **URNS OFF**, then release the button.

STEP 3
Finished! You can now start setting up the ECO Plugs APP with the Wi-Fi In-Wall

SMARTPHONE SETUP



DOWNLOAD THE ECO PLUGS APP:

You can download the ECO Plugs App from either the Apple APP Store (iPhone) or the Google Play Store (Android)

Scan the QR Codes below or search for 'ECO Plugs'



(iOS 7 or higher)



(Version 4 or higher)

*If you purchase more than one ECO In-Wall Switch, setup each device one by one.

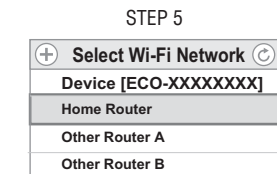
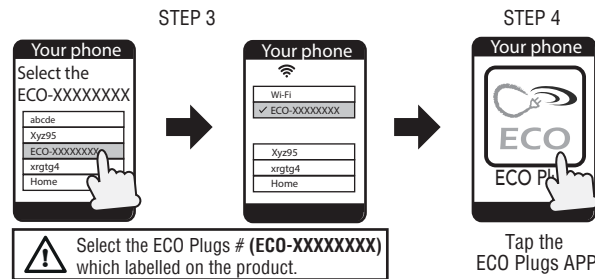
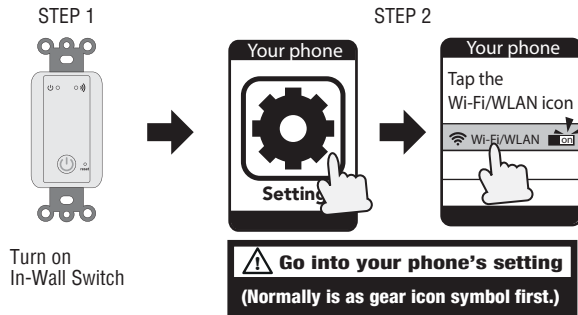

Select the Wi-Fi home router that you want to connect to the Wi-Fi In-Wall Switch or tap (C) (EX: Home Router)



Fill in all your information.

*If this ECO-XXX network does not show in your list, perform a factory RESET of the Wi-Fi In-Wall Switch

*If your router does not show up in the list, press the + icon to manually enter your router's information

STEP 7

EX: USA <input checked="" type="checkbox"/> USA <input type="checkbox"/> Canada <input type="checkbox"/> Other Enter Zip Code: <input type="text" value="2142 (Cambridge)"/> Name Device: <input type="text" value="(Named This Device)"/> Wi-Fi Router(WLAN): <input type="text" value="Home Router"/> Enter Wi-Fi Router Password: <input type="text" value="(Wi-Fi's password, if needed)"/>	EX: CANADA <input type="checkbox"/> USA <input checked="" type="checkbox"/> Canada <input type="checkbox"/> Other Phone Area Code: <input type="text" value="416 (Toronto)"/> Name Device: <input type="text" value="(Named This Device)"/> Wi-Fi Router(WLAN): <input type="text" value="Home Router"/> Enter Wi-Fi Router Password: <input type="text" value="(Wi-Fi's password, if needed)"/>
--	---



Fill in Country, Zip Code (USA Only)
Phone Area Code (CANADA Only)

Name Device (Lamp, TV, small appliances) and Router Password, click the **SAVE SETTING** or **JOIN** button.

*iOS: If you can't find the **Join** button, please click in the password section.

*For Canada: Please select the Canada, entering the phone area code instead of zip code.

*Your smartphone should reconnect to your home router. If it does not, go back into your phone WiFi settings to connect back to it.

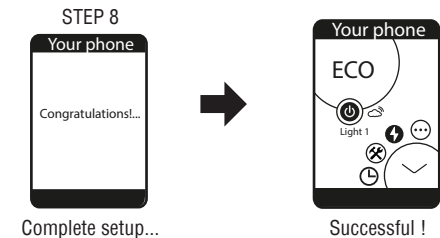

ADD MULTI WI-FI IN-WALL SWITCH TO THE APP

Repeat steps 1-8 for each additional device. Remember to give each device a different name (for example, Light 1, Light 2, etc.).

*Note: each controlled device requires a separate Wi-Fi In-Wall Switch.

ADD MULTIPLE USERS TO ECO PLUGS

Repeat the steps below for each additional user

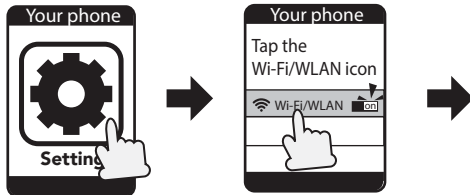

Tap iOS's setting gear icon
Tap Android's Wi-Fi/WLAN icon
(Not the ECO Plugs APP)

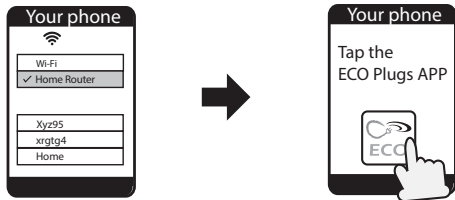

Link to the same router as used by the first smartphone (EX: Home Router)

* For cloud function. Refer to EXPLORE THE TIMER SETTING

CONTROL MULTIPLE GEMINIS

***ONLY IF YOU HAVE MORE THAN ONE WI-FI IN-WALL SWITCH PROGRAMMED ON THE ECO PLUGS APP:** You can choose which Wi-Fi In-Wall Switch (EX: Light 1, Light 2, Light 3, etc.) you want to control by sliding the desired icon to the lower left position.

The Wi-Fi In-Wall Switch name (EX: Light 1, Light 2, etc.) will change color from **white** to **yellow**. The chosen device is now able to be programmed or edited; such as changing timer settings, setting security settings, updating the cloud service, etc.

***Note:** YOU CAN CONNECT TO A MAXIMUM OF TWELVE (12) WI-FI IN-WALL SWITCH VIA THE ECO PLUGS APP.



EXPLORE THE ECO PLUGS APP ICONS

- More** - Learn more about ECO Plugs app, including a Q & A section.
- Electric Bill** - Function is not available on this device.
- Setting** - Setting your Wi-Fi In-Wall Switch, such as transfer local Wi-Fi into cloud mode, or rename the device.
- Timer** - Setting On/ Off programs (up to a maximum of 12 Custom On/ Off events).
- Mail Box** - Welcome share any feedback on this App.

EXPLORE THE TIMER FUNCTION

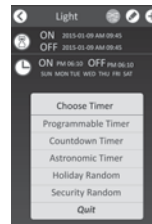

- Programmable Timer** - Setting On/ Off events. Select ON time and OFF time. (EX: ON - 06:30PM OFF - 05:00AM) Can also select what day(s) of the week it effects.
- COUNTDOWN TIMER** - You will select an ON date (EX: 03/29/17) and time (EX: 07:30PM) and an OFF date (EX: 04/02/17) and time (EX: 05:00AM)
- ASTRONOMIC TIMER** - Wi-Fi In-Wall Switch will turn ON/OFF at sunset or sunrise. Can also select what day(s) of the week it effects.
- HOLIDAY RANDOM** - The Wi-Fi In-Wall Switch will turn ON/OFF at random times based on three simple settings (Night, Day, All Day)
- SECURITY RANDOM** - The Wi-Fi In-Wall Switch will turn ON/OFF at random times between a set of selected start and end dates and times.
- PROGRAMMABLE RANDOM** - This icon increases or decreases the time of your ON/OFF events by 30 minutes

PROGRAMMING THE TIMER

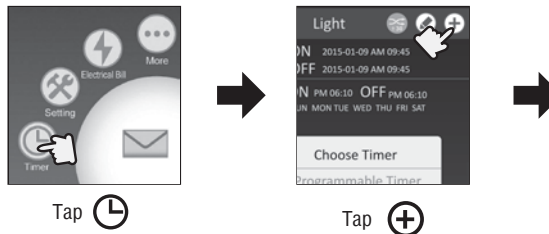

*When the device change color from white to yellow

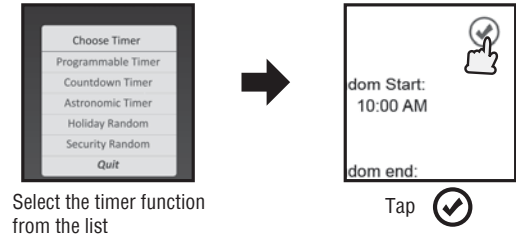

Select the timer function from the list

Tap

*When setting up a new timer function, make sure the Wi-Fi In-Wall Switch is connected to your home/office router, and that the Wi-Fi In-Wall Switch is plugged into a 120Vac wall outlet. The Wi-Fi In-Wall Switch will also remember programmed timers when removed from power.

NOTE: If you preprogram it and move it to a different area with completely different WiFi signals, the Wi-Fi In-Wall Switch will attempt to connect to one of these unsuccessfully. This will make the preprogrammed timer NOT function. In this case, you may have to RESET the Wi-Fi In-Wall Switch and set it to a router in the area.

EDITING THE PROGRAMMED TIMER

iOS



*When the device change color from white to yellow

Android

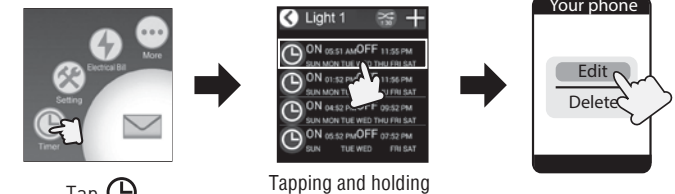

*When the device change color from white to yellow

EXPLORE THE TIMER SETTING

DST - Daylight Saving Time : The time will automatically move ahead 1 hour on Sunday of the second week of March @ 02:00am, and will automatically adjust back 1 hour on Sunday of the first week in November @ 02:00am every year.

CLOUD SERVICE - Activates remote access function of the Wi-Fi In-Wall switch through 3G, 4G, LTE, public WiFi, or other WiFi routers. You can then access your Wi-Fi plug from almost anywhere in the world!

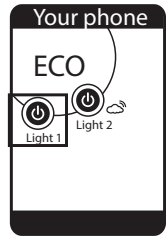

Cloud status INACTIVE

*When the device change color from white to yellow



Tap

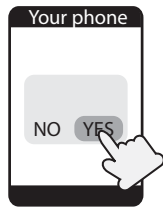
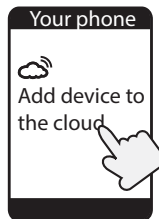

Cloud status ACTIVATED

AMAZON ALEXA SETUP

Connecting your ECO Plugs device to Amazon Alexa

Step 1
Open the ECO PLUGS app and click on "Settings"

(If you have multiple devices, slide the desired device icon to the lower left until the desired device's name changes to yellow)



Step 2
Tap "Connect to Amazon Alexa" Enter your Alexa account (This is the email address associated with your Alexa account) Then tap "YES"

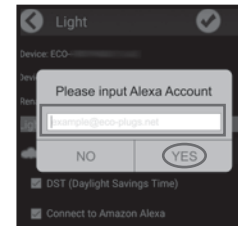
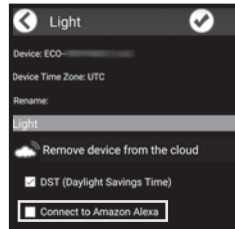

Step 3
Open the Amazon Alexa app. Go to the menu button in the top left corner and click on "Smart Home"

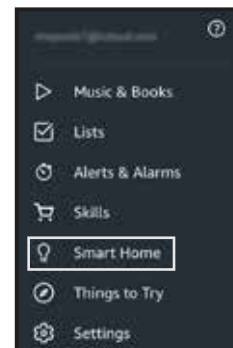
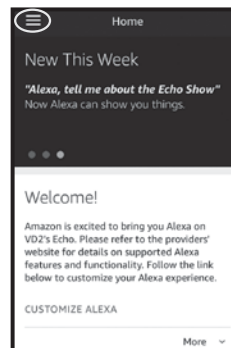

Step 4
Tap "Smart Home Skills", then click on "Enable Skills"

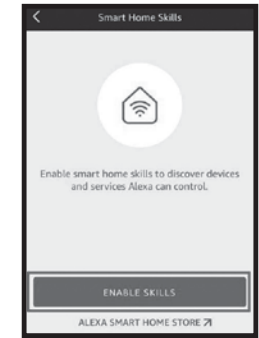
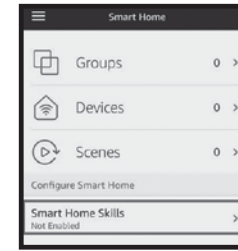

Step 5
Search for "ECO Plugs" Click on "Enable"

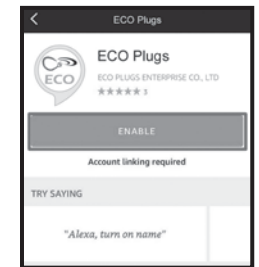
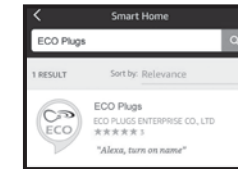

Step 6
Enter your Amazon Alexa Account (This is the email address associated with your Alexa account) Then tap "Authorize"



Click on "Yes" to allow access

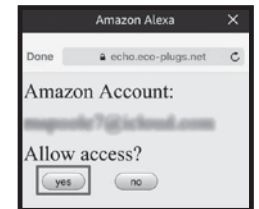

Step 7
Link SUCCESSFUL!
Go back to the Amazon Alexa App

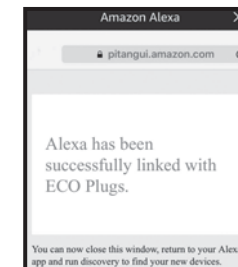

Step 8
Tap "Discover Devices"

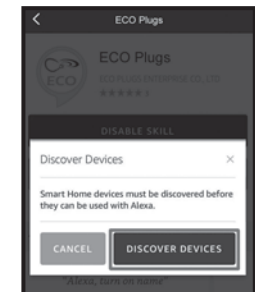

Step 9

If the device is NOT discovered at step 8:
In the Amazon Alexa app, go to the menu in the top left corner and click on “Smart Home”. Then, click on “Devices”, and then “Discover”.

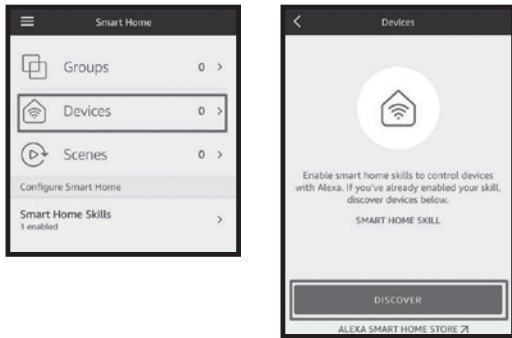

MORE INFORMATION

If you have further inquiries regarding the set up Wi-Fi Plug, please search “ECO Plugs” on the YouTube, or send an email to us.

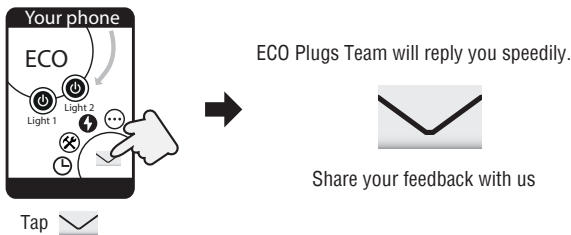
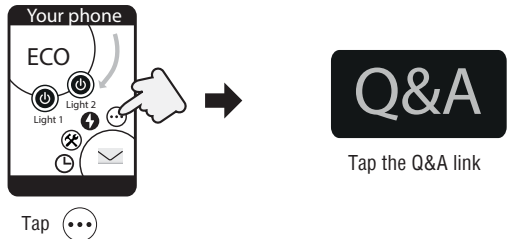
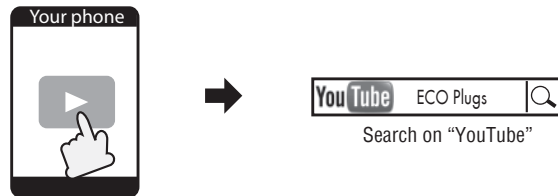

Federal Communications Commission Interference Statement

This equipment has been tested and found to comply with the limits for Class B digital device, pursuant to part 15 of the FCC rules. These limits are designed to provide reasonable protection against harmful interference in a residential installation. This equipment generates, uses and can radiate radio frequency energy and, if not installed and used in accordance with the instructions, may cause harmful interference to radio or television reception, which can be determined by turning the equipment off and on, the user is encouraged to try to correct the interference by one or more of the following measures:

- Reorient or relocate the receiving antenna.
- Increase the separation between the equipment and the receiver.
- Connect the equipment into an outlet on a circuit different from that to which the receiver is connected.
- Consult the dealer or an experienced radio/TV technician for help.

This device complies with Part 15 of the FCC Rules. Operation is subject to the following two conditions:

1. This device may not cause harmful interference.
2. This device must accept any interference received, including interference that may cause undesired operation of the device.

FCC Caution: Any changes or modifications not expressly approved by the party responsible for compliance could void the user's authority to operate this equipment.

FCC Radiation Exposure Statement:

This equipment complies with FCC radiation exposure limits set forth for an uncontrolled environment. This equipment should be installed and operated with minimum distance 20cm between the radiator and your body.

Contains FCC ID: PAGECO-PLUGS

CAUTION

- Do not attach a device that exceeds the unit ratings as described in the Safety Information section of this manual.
- Wattage of lamps or appliances controlled must NOT exceed rated capacity.
- FOR INDOOR USE ONLY.
- Installation by a licensed electrician to local, state and national codes is recommended.
- Remove wall plate and make sure both hot and neutral wires are present in the junction box. If both wires are not present, additional wiring will be necessary before installation can be completed.
- Check that all wire connections are secure.
- Place all wires inside junction box. Fit switch into junction box.
- Reconnect electrical power.

Apple is a registered trademark of Apple Inc.

Android, Google Play and the Google Play logo are trademarks of Google Inc.

iOS is a trademark or registered trademark of Cisco in the US and other countries and is used under license.

The Wi-Fi certified logo and Wi-Fi® are registered trademarks of Wi-Fi Alliance.

Made in China